

ONE
BOSTON PLACE

17TH FLR | 9,996 SF (2,062 MEZZ & 7,934 MAIN)

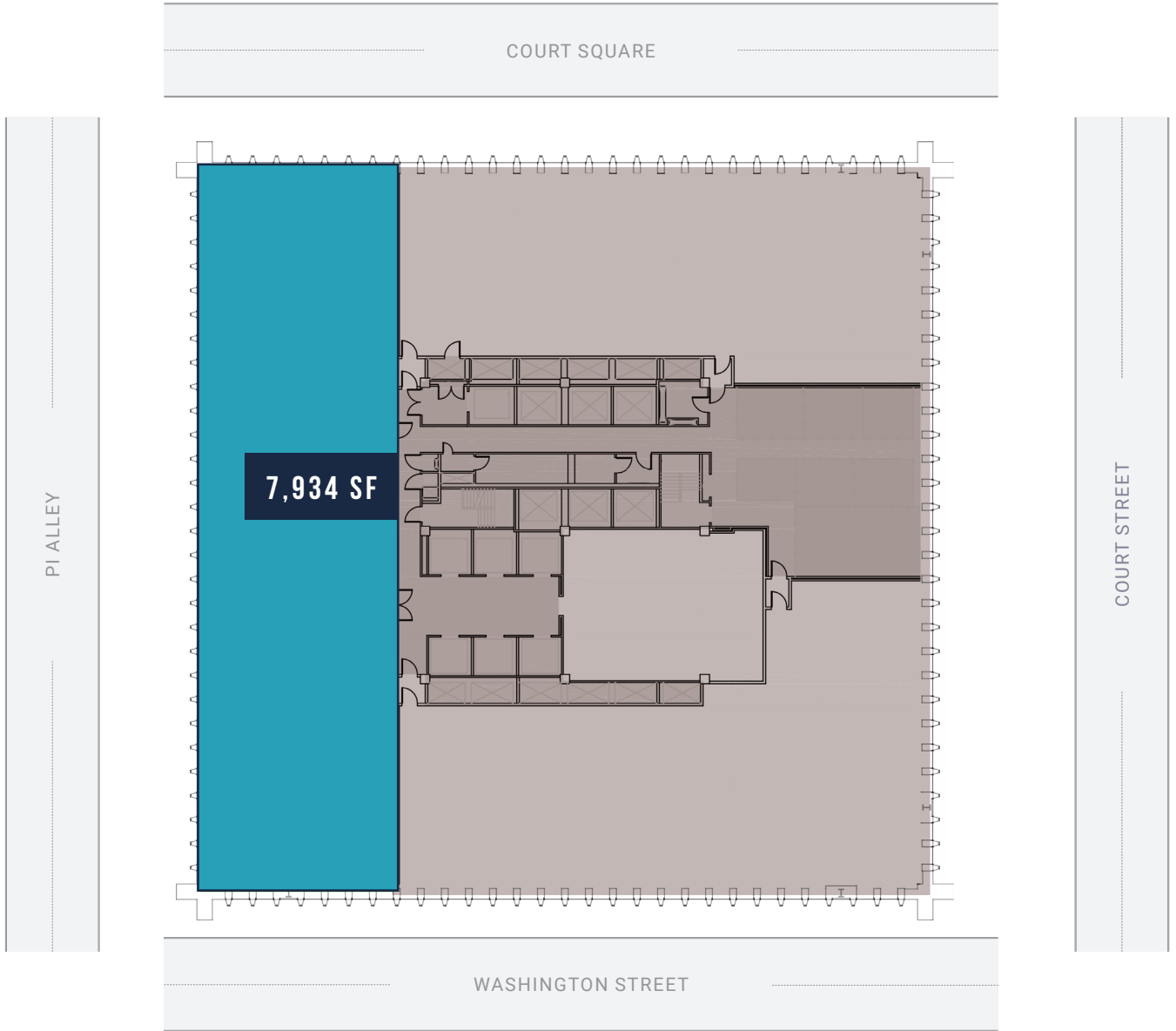

FOR ONE BOSTON PLACE LEASING INFORMATION PLEASE CONTACT:

GIL DAILEY

617.863.8551

gdailey@ngkf.com

JASON CAMERON

617.863.8129

jcameron@ngkf.com

DAVE MARTEL

617.863.8525

dmartel@ngkf.com

CBRE

**Ivanhoé
Cambridge**

**Newmark
Knight Frank**

nuveen
REAL ESTATE

ONEBOSTONPLACE.COM